

Roof Cross Rack

Caution!



It is important that the roof system and accessories are properly and securely attached to the vehicle, according to instructions and only used for its predetermined purpose - per instruction manual. Periodic inspections for wear and tear of the roof system and accessories are paramount. It is the users' responsibility to fully understand the instruction manual prior to installation. Precautions are to be taken during installation, understanding limitations of the roof system and prevention of possible damage to vehicle, property and/or bodily injury.

YT-95 Series

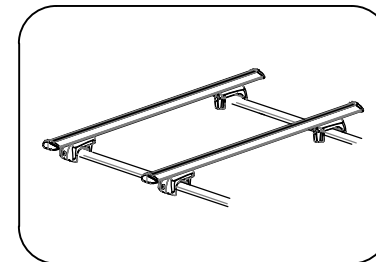

Important!

Before each journey, make sure that your roof system is in good functional condition, double check that all screws, straps, hooks and padding are all secured and tightened properly. Some types of sunroof and radio antenna cannot be used when the roof system is fitted.

- 1.) Every time the unit is fitted, double check that the roof system is securely fitted by pushing and pulling it out of locked position. For a secure fit, you should not be able to move any part.
- 2.) Roof systems security should be checked after a short distance and thereafter at regular suitable intervals. Tighten securing bolts, nuts and straps when necessary.
- 3.) Make sure that vehicle surfaces are free of grit, dirt and sand to prevent paint impairment during roof system installation and use.
- 4.) When not in use, the system should be removed from the vehicle and stored properly and safely.

Warning!

- 1.) When carrying loads on the roof system, it should not exceed the systems width and should always be spread evenly at the lowest centre of gravity. **DO NOT EXCEED THE MAXIMUM ALLOWABLE WEIGHT TO BE CARRIED PER SYSTEM.**
- 2.) When carrying long loads, be sure to secure both at the front and rear of the vehicle
- 3.) Be sure to remove all detachable equipment, such as flasks, headlight, fins and pumps to prevent loss of property, possible bodily injury and vehicle damage.
- 4.) The load limit, load length and load width carried on the roof system must conform to local government regulations for road safety and it is users' responsibility to abide by.
- 5.) Road speed should always be adjusted accordingly and suit the driving conditions, particularly taking into account, road type & quality, wind conditions, traffic and applicable speed limits.
- 6.) Be aware that total vehicle height increases with upright loads or systems.
- 7.) Vehicle characteristic for driving and braking change, pay particular attention to side wind.

PLEASE DRIVE SLOWLY, SAFELY AND SECURELY WITH YOUR CARRIER RACK.

1

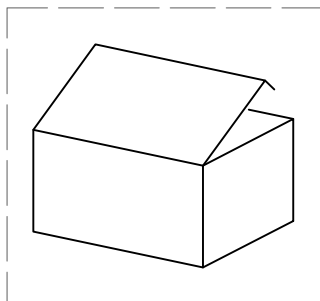

YT-95

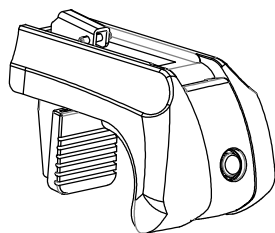

x4

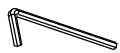

x1



x1

option

Aero wing crossbar

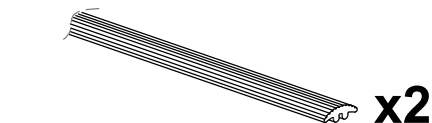

x2

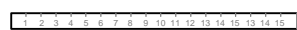

x4

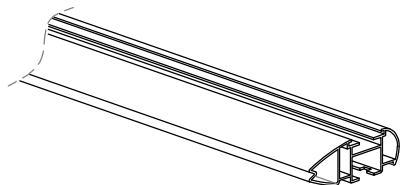

x2



x1



x2



x2

Edge crossbar

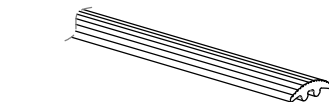

x2



x4

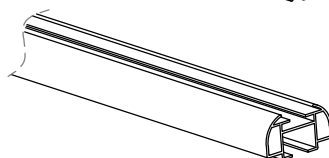

x2



x4

6

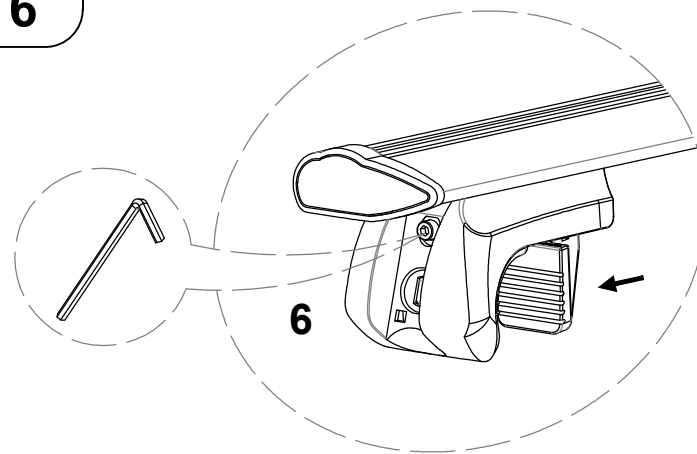

6

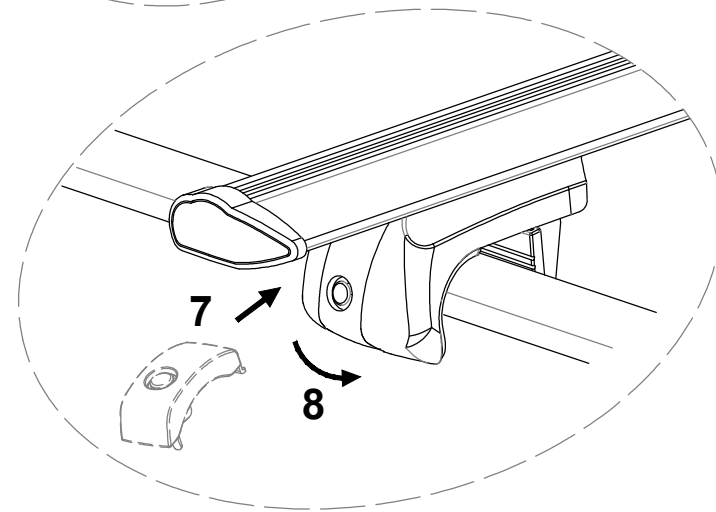

7

8

Aero wing crossbar

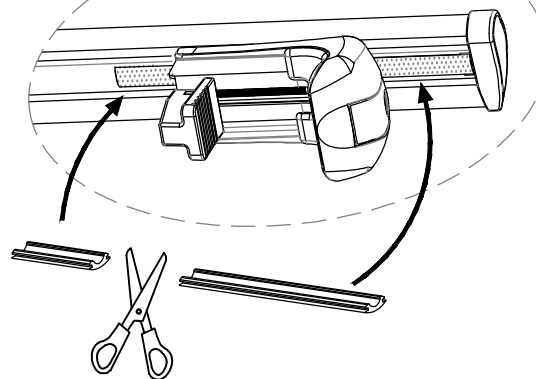
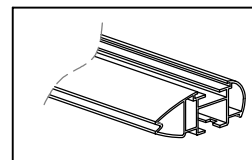

5

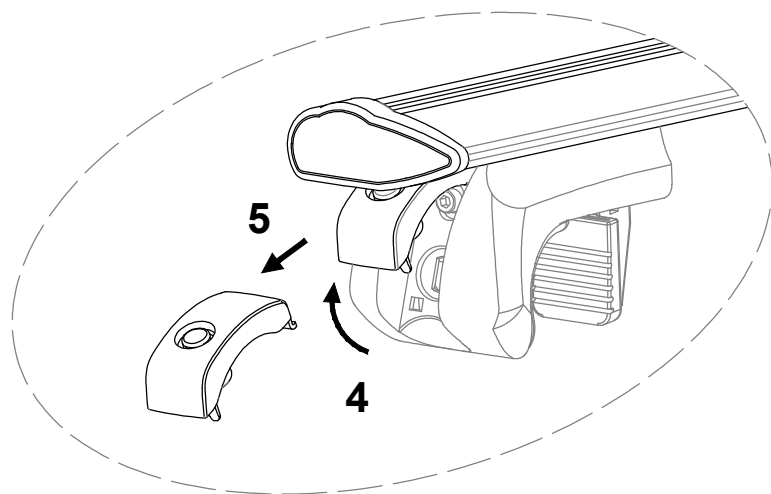
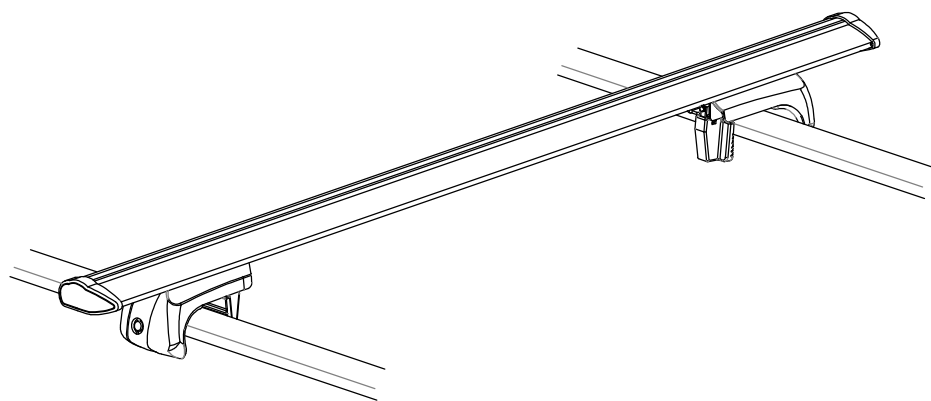
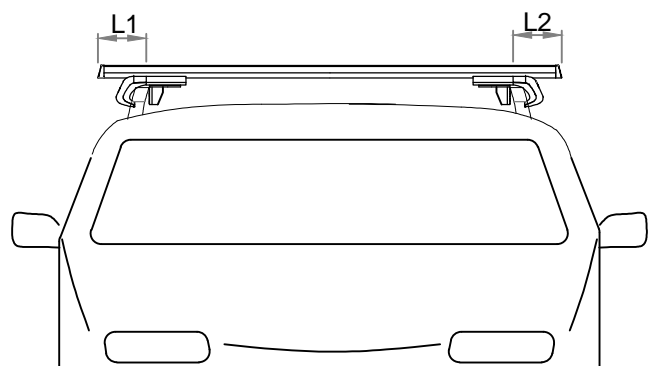

2

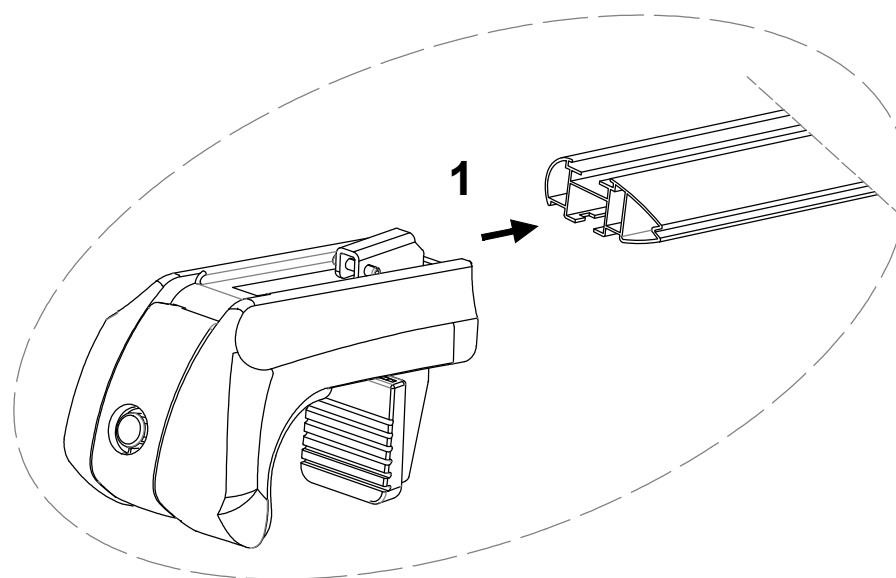
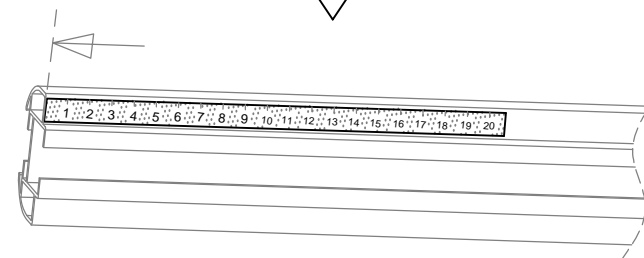
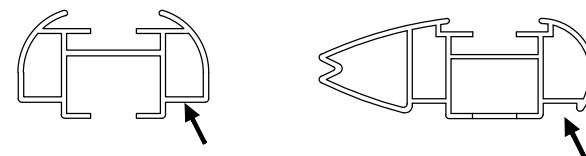
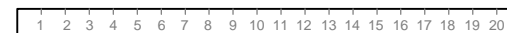

3

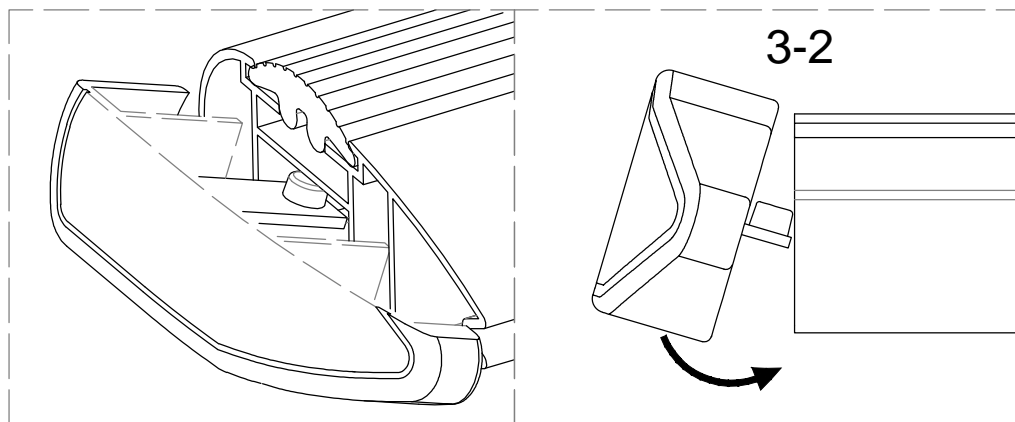
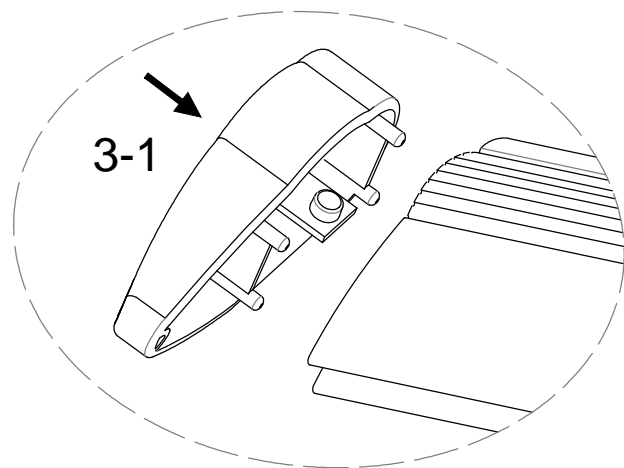
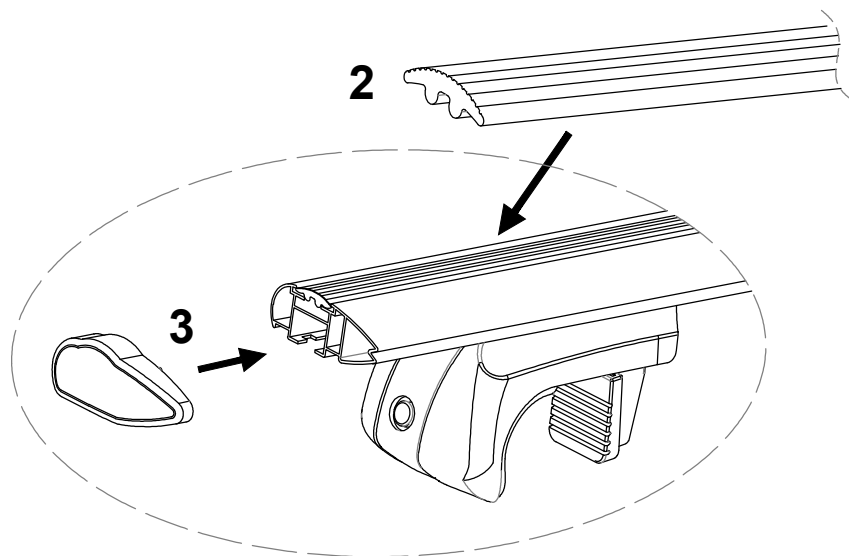

4

REMOVE

